

# FEMALE RUN TEE

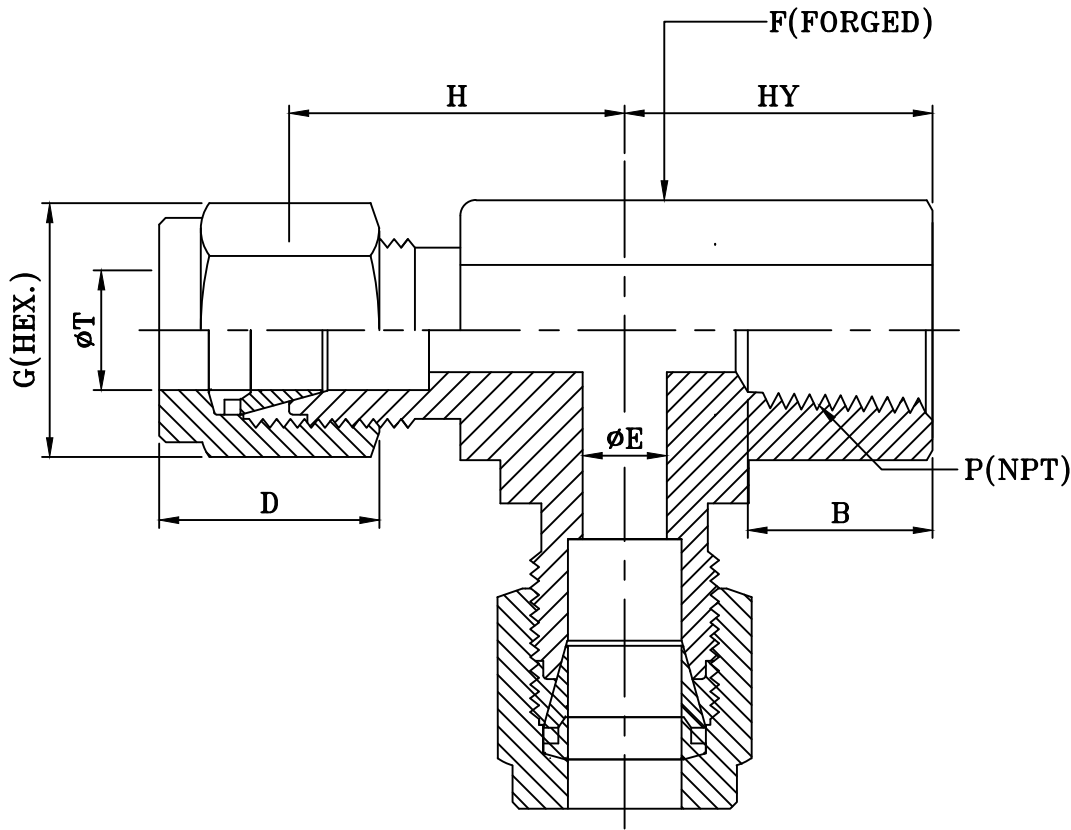

PART NO	P	T	F	G	B	D	E	H	HY
FRT2N2T	1/8"	1/8"	11.0	11.1	9.5	11.0	2.4	18.0	19.0
FRT2N4T	1/8"	1/4"	12.5	14.2	9.5	12.7	4.8	19.6	19.0
FRT4N4T	1/4"	1/4"	14.0	14.2	14.2	12.7	4.8	22.4	22.4
FRT4N6T	1/4"	3/8"	17.5	17.5	14.2	14.5	7.1	23.9	22.4
FRT6N8T	3/8"	1/2"	20.5	22.2	14.2	17.5	9.5	25.9	22.4
FRT8N8T	1/2"	1/2"	22.0	22.2	19.0	17.5	10.3	29.7	28.5

NOTES:  
 1) ALL DIMENSIONS ARE IN MM. UNLESS SPECIFIED.  
 2) PARTS TO BE FREE FROM BURR.  
 3) GENERAL TOLERANCE : ± 1MM.  
 4) REF. STD. : ASTM F1387 / ASME B1.20.1.

					DATE	BY	CUSTOMER :		
				DRAWN	01.04.10	AL	TITLE : FEMALE RUN TEE		
				CHECKED			<div>Swastik Engg. Works</div> <div>GOREGAON (EAST), MUMBAI-400 063.</div>		
				APPROVAL					
NO	DESCRIPTION	SIGN	DATE						
REVISION				SCALE : NTS			MATERIAL :	DWG. NO : SEW-FRT-N	REV.: